

Enclosure
DIL 8

Date: 22.10.2014
ROHS-compliance

Dimensions

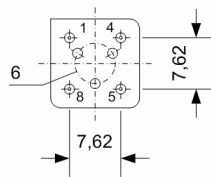
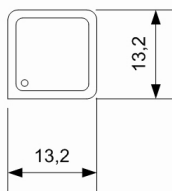
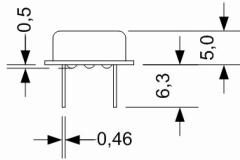

PIN CONNECTIONS

- 1 NC
- 2 GND
- 3 RF Output
- 4 V_{DD}



Parameter	MIN	TYP	MAX	UNIT	NOTE
Frequency range	10		40	MHz	⁽¹⁾
Frequency stability					
Nominal tolerance		± 3		ppm	V _c = V _{dd} / 2
vs. Temperature in the operating temp. range		± 1		ppm	⁽²⁾
vs. supply voltage			± 0.2	ppm	
vs. load change			± 0.2	ppm	
aging			< ± 1	ppm	+25°C, 1 st year
Frequency adjustment					
Voltage control sensitivity	7		15	ppm / V	
Voltage control range	0		V _{DD}	V	
Slope (Δf / ΔV _c)		positive			
Supply voltage V _{DD}		3.3		V	
Current consumption		6		mA	⁽¹⁾
RF output					
Signal waveform		HCMOS			
Load		10		pF	
Duty cycle	45		55	%	
Rise / fall time		3		ns	
Start-up time		2		ms	
Operating temperature range	- 40		+ 85	°C	
Storage temperature range	- 55		+ 125	°C	
Phase noise		< -120		dB _c /Hz	at 100 Hz
Enclosure	DIL 8				(see drawing)
ESD rating (HBM)			2	kV	

Note: ⁽¹⁾ f_{min} = 5.0 MHz, divider f₀ / 2

⁽²⁾ df₀ = ± 0.3 ppm at temperature range +10°C ... +50°C